

BUILT *to* LAST

The Taft Historic House at 200

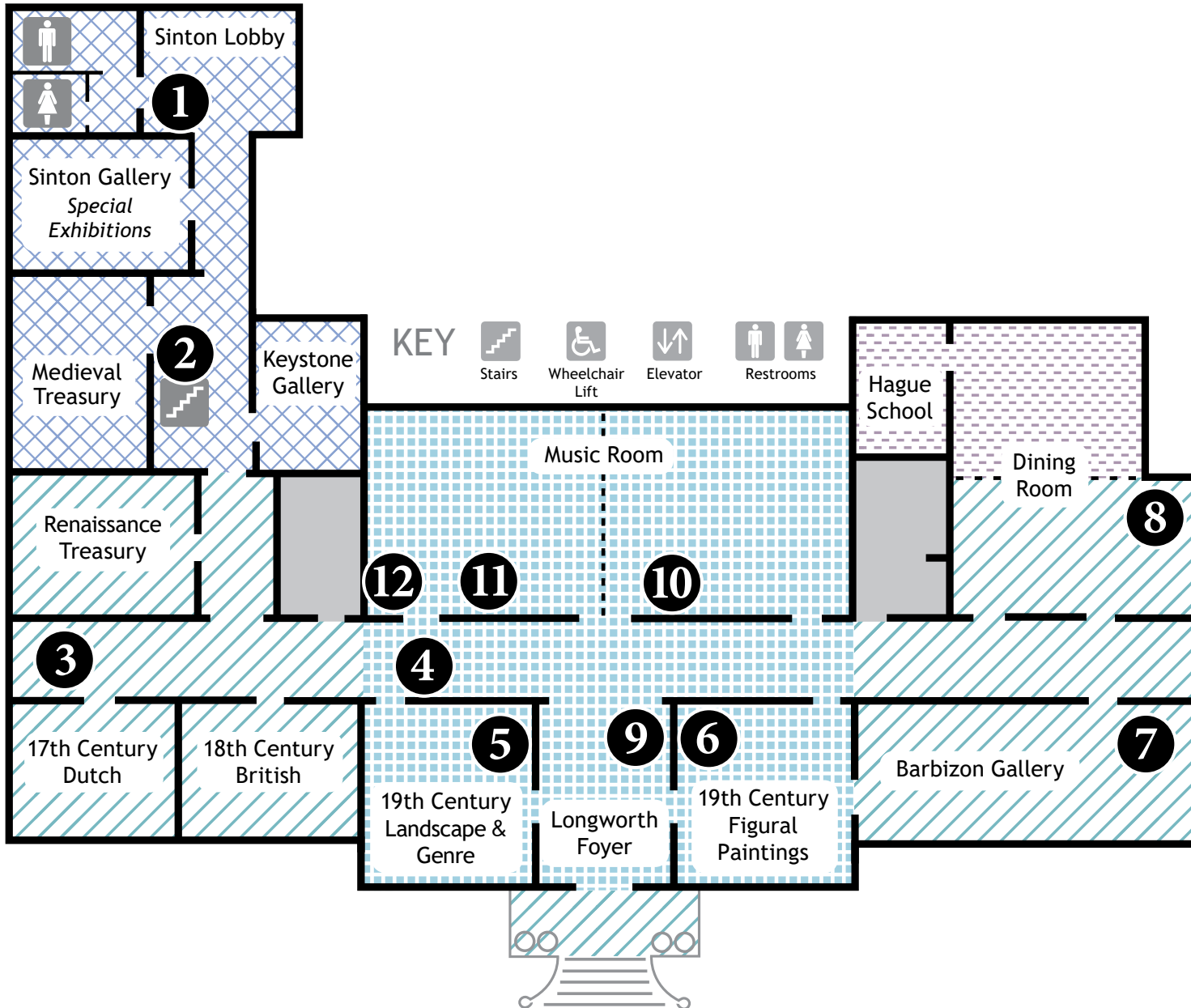

ABOUT 1820
Martin and Ann Baum built the original house, Belmont Square.

1830S
Nicholas and Susan Longworth expanded the house's footprint, adding north and south wings in addition to a front portico.

ABOUT 1890
David Sinton extended the north wing to create a private suite. Over the driveway, he added a porte cochere—an extended roof sheltering people as they entered and exited vehicles—that was removed in 1931 or 1932.

1910
Charles and Anna Taft hired architects Elzner & Anderson to enlarge the dining room and install a plaster ceiling appropriate to the original period of the house.